

COLLECT_{AND}DRAIN[®]

Model 5400

QUALITY COMPONENTS FOR FIRE SPRINKLER SYSTEMS

Dry and Pre-Action System Auxiliary Drains with Freeze Protection

The AGF COLLECT_{AND}DRAIN Model 5400 is a fully assembled auxiliary drain (drum drip, low-point drain) designed to collect moisture that condenses in dry and pre-action fire sprinkler systems, while minimizing the system's air pressure loss when draining.

The Model 5400 is designed to safeguard the auxiliary drain from colder temperatures, preventing costly system freeze-ups. The heated and insulated, locking steel cabinet shelters the auxiliary drain, heating element, and control panel from exterior elements. The internal heater features a thermostat that operates only when needed, reducing energy use while maintaining a temperature safely above freezing. An external temperature gauge allows operators to monitor the cabinet's internal temperature without having to open the cabinet. The Model 5400H includes a Hot Operation Trouble (HOT) Monitor that tracks the heater's on/off cycles and compares that information against it's own internal thermostat to make sure the heater is performing correctly. The auxiliary drain features a float switch that monitors water levels. When the water's level reaches capacity the float switch activates an audible alarm and flashes a visual alert, this helps notify personnel that draining is required. The Model 5400 can be wired to the BMS or fire control panel for remote notification. For systems that need real-time notification the Model 5400D includes a Auto-Dialer that provides a personalized notification for up to four telephone numbers.

Features

- Galvanized or Black Steel Piping Components
- Fully Assembled, Easy Installation
- Heated Cabinet
- Float Switch Water Level Monitoring
- Highly Visible NFPA Signage
- BMS or Fire Control Panel Integration
- Optional All-Weather Cover

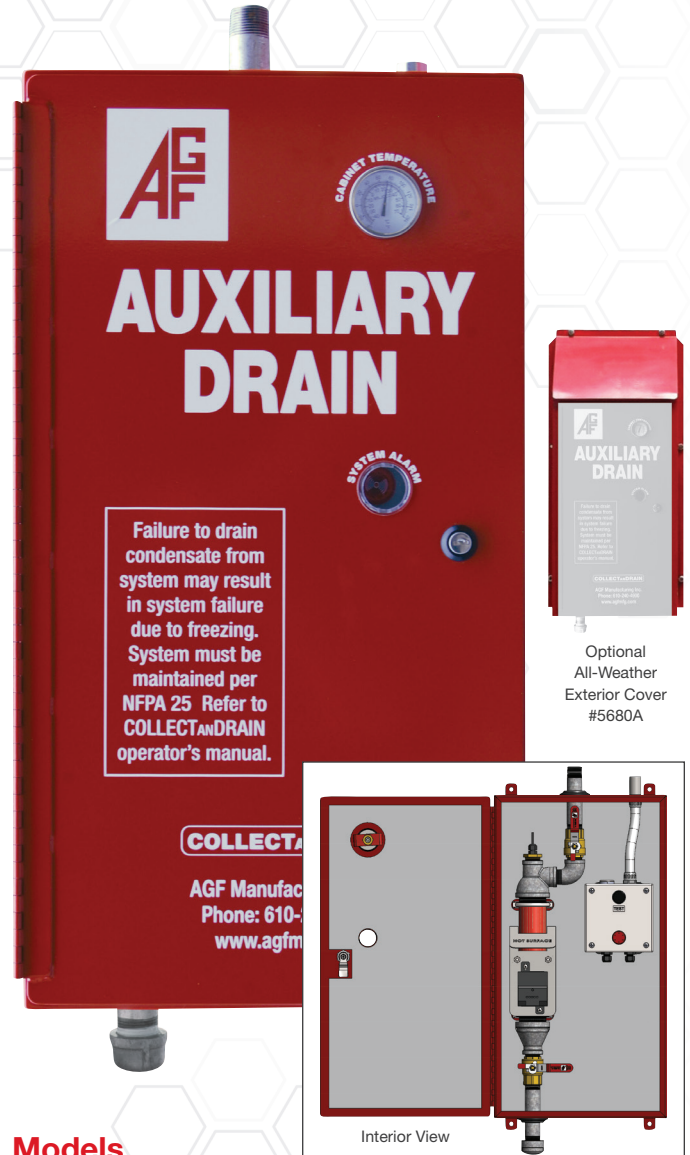

Models

Part Numbers			
Piping		with Auto-Dialer	with HOT Monitor
Galvanized	5400A	5400D	5400H
Black Steel	5400B	5400BD	5400BH
Exterior Cover - Recommended for Outdoor Installations			
5680A			



Components

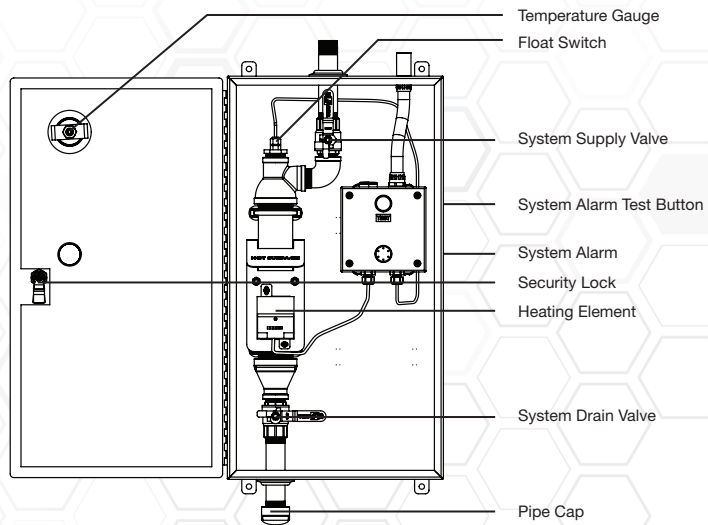

Dimensions

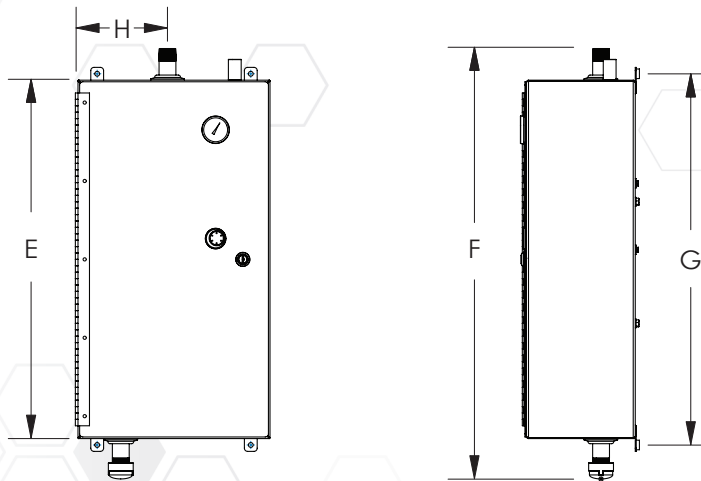
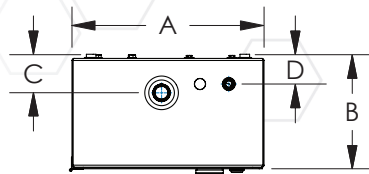

Model	A	B	C	D	E	F	G	H
5400	15" (381 mm)	9" (227 mm)	3" (77 mm)	2 3/8" (59 mm)	28" (711 mm)	33 3/4" (854 mm)	29" (737 mm)	7" (178 mm)

Sizes have been rounded to the highest millimeter

USA Patent and Other Patents Pending

For use on dry and pre-action
fire sprinkler systems.

Pipe Size

1"

Connections

Inlet..... NPT

Outlet..... NPT

Installation Orientation

Vertical

Electrical Requirements

120VAC, 3 Amps

Materials

Cabinet..... Steel

Body..... Galvanized or Black Steel

Valves..... Brass

Handles..... Steel

Pipe Cap..... Steel

Rating

300 PSI

Compliance

NFPA 13

NYC-BSA No. 720-87-SM



AGF Manufacturing Inc.
100 Quaker Lane, Malvern, PA 19355

Phone: 610-240-4900

Fax: 610-240-4906

www.agfmfg.com

Job Name: _____

Architect: _____

Engineer: _____

Contractor: _____