

# COLLECT<sub>AND</sub>DRAIN<sup>®</sup>

## Model 5450

### QUALITY COMPONENTS FOR FIRE SPRINKLER SYSTEMS

#### Self-Maintaining Dry and Pre-Action System Auxiliary Drains with Freeze Protection

The AGF COLLECT<sub>AND</sub>DRAIN Model 5450 is a fully assembled auxiliary drain (drum drip, low-point drain) designed to collect moisture that condenses in dry and pre-action fire sprinkler systems, while minimizing the system's air pressure loss when draining.

The Model 5450 is designed to safeguard the auxiliary drain from colder temperatures while self-maintaining it's collection assembly, preventing costly system freeze-ups. The heated and insulated, locking steel cabinet shelters the auxiliary drain, heating element, y-strainer, drain trap, and control panel from exterior elements. The internal heater features a thermostat that operates only when needed, reducing energy use while maintaining a temperature safely above freezing. An external temperature gauge allows operators to monitor the cabinet's internal temperature without having to open the cabinet. The Model 5450H includes a Hot Operation Trouble (HOT) Monitor that tracks the heater's on/off cycles and compares that information against it's own internal thermostat to make sure the heater is performing correctly. The self-maintaining feature incorporates a y-strainer and drain trap that automatically sheds water from the collection assembly when the level reaches approximately, 80%. The auxiliary drain also features a float switch that monitors water levels. If the water's level reaches capacity the float switch activates an audible alarm and flashes a visual alert, this helps notify personnel that draining is required, and that the self-maintaining feature may require maintenance. The Model 5450 can be wired to the BMS or fire control panel for remote notification.

#### Features

- Galvanized or Black Steel Piping Components
- Y-Strainer and Drain Trap for Self-Maintenance
- Heated Cabinet
- BMS or Fire Control Panel Integration
- Optional All-Weather Cover



#### Models

Part Numbers		
Piping		with HOT Monitor
Galvanized	5450A	5450H
Black Steel	5450B	5450BH
Exterior Cover - Recommended for Outdoor Installations		
5680A		



## Components

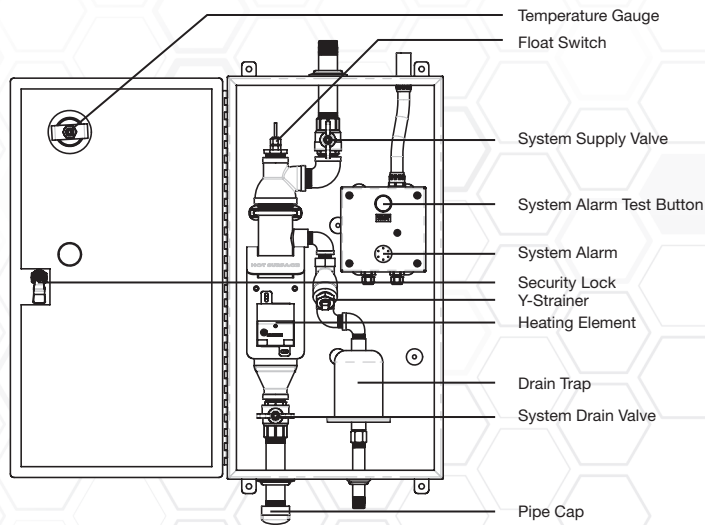

## Dimensions

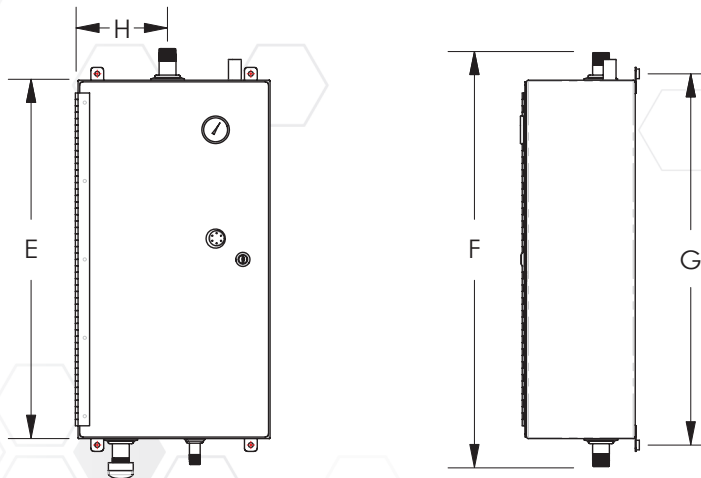
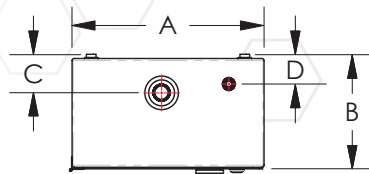

Model	A	B	C	D	E	F	G	H
5450	15" (381 mm)	9" (227 mm)	3" (77 mm)	2 3/8" (59 mm)	28" (711 mm)	32 3/8" (854 mm)	29" (737 mm)	7" (178 mm)

Sizes have been rounded to the highest millimeter

USA Patent and Other Patents Pending

For use on dry and pre-action  
fire sprinkler systems.

## Pipe Size

1"

## Connections

Inlet..... NPT

Outlet..... NPT

## Installation Orientation

Vertical

## Electrical Requirements

120VAC, 3 Amps

## Materials

Cabinet..... Steel

Body..... Galvanized or Black Steel

Valves..... Brass

Handles..... Steel

Pipe Cap..... Steel

## Rating

300 PSI

## Compliance

NFPA 13

NYC-BSA No. 720-87-SM



**AGF Manufacturing Inc.**  
100 Quaker Lane, Malvern, PA 19355

Phone: 610-240-4900

Fax: 610-240-4906

[www.agfmfg.com](http://www.agfmfg.com)

Job Name: \_\_\_\_\_

Architect: \_\_\_\_\_

Engineer: \_\_\_\_\_

Contractor: \_\_\_\_\_