

COLLECT_{AN}DRAIN[®]

Model 5500

QUALITY COMPONENTS FOR FIRE SPRINKLER SYSTEMS

Automated Dry and Pre-Action System Auxiliary Drains with Freeze Protection

The AGF COLLECT_{AN}DRAIN Model 5450 is a fully assembled auxiliary drain (drum drip, low-point drain) designed to collect moisture that condenses in dry and pre-action fire sprinkler systems, while minimizing the system's air pressure loss when draining.

The Model 5500 is designed to automate maintenance and safeguard the auxiliary drain from colder temperatures to prevent costly system freeze-ups. The heated and insulated, locking steel cabinet shelters the auxiliary drain, heating element, and programmable logic control (PLC) from exterior elements. The internal heater features a thermostat that operates only when needed, reducing energy use while maintaining a temperature safely above freezing. An external temperature gauge allows operators to monitor the cabinet's internal temperature without having to open the cabinet. The Model 5500 auxiliary drain features a float switch and motorized supply and drain valves. The motorized supply and drain valves can be programmed to drain the collection assembly automatically, per NFPA 25 standards when the float switch is tripped. If the Model 5500 is not programmed for full automation and the water's level reaches capacity the float switch will activate an audible alarm and flash a visual alert to notify personnel that draining is required. The Model 5450 can be wired to the BMS or fire control panel for remote notification.

Features

- Galvanized or Black Steel Piping Components
- Motorized Supply and Drain Valves
- Heated Cabinet
- Programmable Logic Control (PLC)
- Float Switch Water Level Monitoring
- BMS or Fire Control Panel Integration
- Optional All-Weather Cover

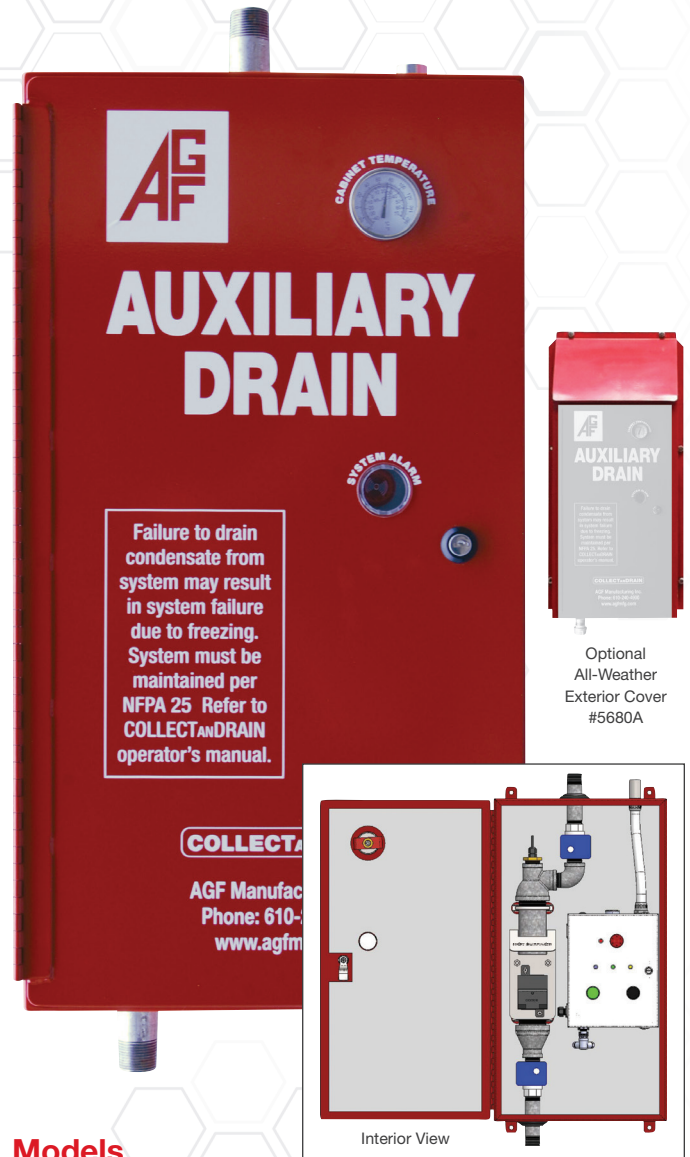

Models

Part Numbers	
Piping	
Galvanized	5500A
Black Steel	5500B
Exterior Cover - Recommended for Outdoor Installations	
5680A	



Components

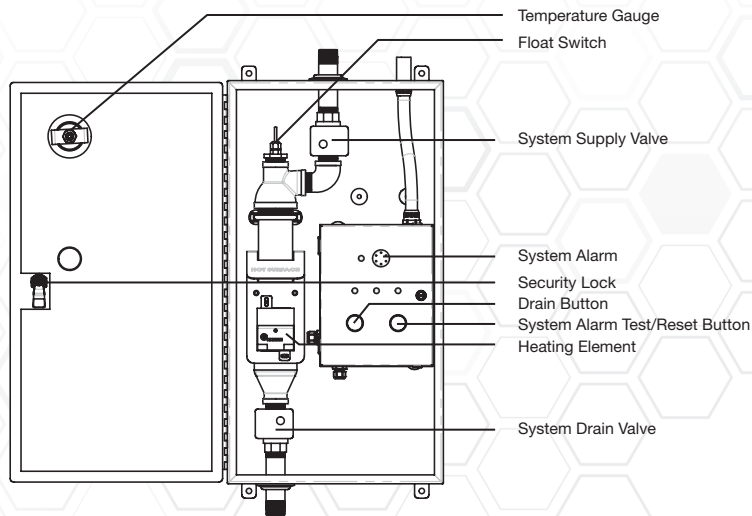

Dimensions

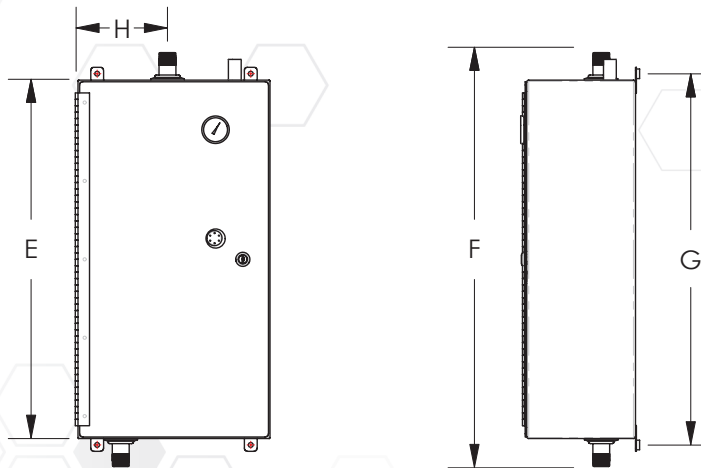
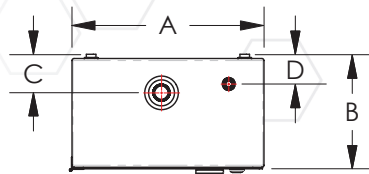

Model	A	B	C	D	E	F	G	H
5500	15" (381 mm)	9" (227 mm)	3" (77 mm)	2 3/8" (59 mm)	28" (711 mm)	32 3/8" (821 mm)	29" (737 mm)	7" (178 mm)

Sizes have been rounded to the highest millimeter

USA Patent and Other Patents Pending

For use on dry and pre-action fire sprinkler systems.

Pipe Size

1"

Connections

Inlet..... NPT

Outlet..... NPT

Installation Orientation

Vertical

Electrical Requirements

120VAC, 3 Amps

Materials

Cabinet..... Steel

Body..... Galvanized or Black Steel

Rating

300 PSI

Compliance

NFPA 13

NYC-BSA No. 720-87-SM



AGF Manufacturing Inc.
100 Quaker Lane, Malvern, PA 19355

Phone: 610-240-4900
Fax: 610-240-4906

www.agfmfg.com

Job Name: _____

Architect: _____

Engineer: _____

Contractor: _____